



RoHS

120 VAC 14 W High-Efficacy  
Dimmable LED Stripe

**Part#:** 331605-000-120-3.7

Job Information <small>Fill out project details for this product below</small>			
<b>Project</b>		<b>Location</b>	
<b>Contact</b>		<b>Date</b>	
<b>Product Number</b>		<b>Fixture Type</b>	

## FEATURES

1. Upgraded design, no extruded conducted wire, adopting dual-colors extrusive PVC tube, more concise and graceful appearance, more flexible bend, and more simplified production process.
2. Simple and quick assembly procedure, without the operation of peeling PVC tube, locking screw and soldering.
3. Driver On Board driverless design, with on board constant current IC driver and rectifier, direct AC power supply without external driver, supports hot plug operation.
4. Over-voltage, over-current and over temperature protection with on-board smart IC driver.
5. Smooth and wide-range (less ineffective area) brightness dimming effed base on patent circuit design, perfed compatible with TRIAC dimmers.
6. Thick and soft PVC tube insures the electrical safety certified by UL standard.
7. Advanced PVC raw material exclusive for outdoor usage, with strong weather resistance in UV resistant and flameproof.
8. All kinds of customized lengths can be realized base on the multiple of increment.
9. Available in IP40 indoor and IP65 outdoor usage.
10. LED rated lifespan in 50,000 hours, ETL [file #5017228, plug-in UL2388 & hardwire UL 15981 and Ro HS approval.
11. 5 years warranty for indoor application, 3 years warranty for outdoor application .



## APPLICATION

Outdoor usage for architecture and landscape lighting.



RoHS

120 VAC 14 W High-Efficacy  
Dimmable LED Stripe

## DIMENSION AND DIAGRAM

Part#: 331605-000-120-3.7

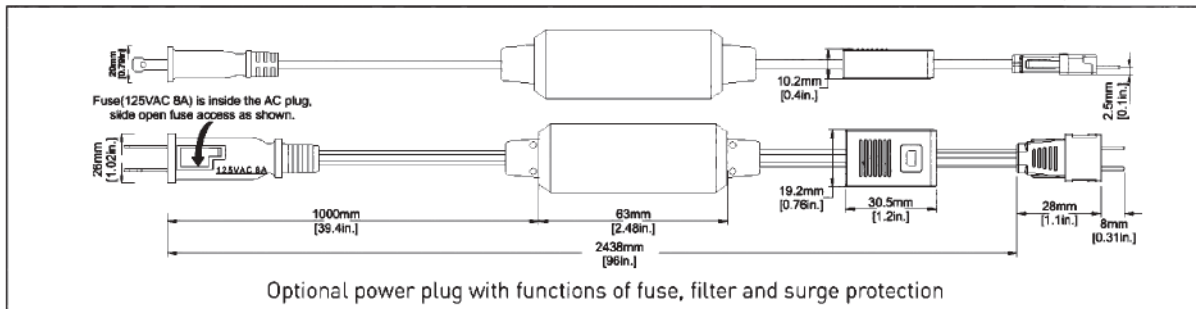
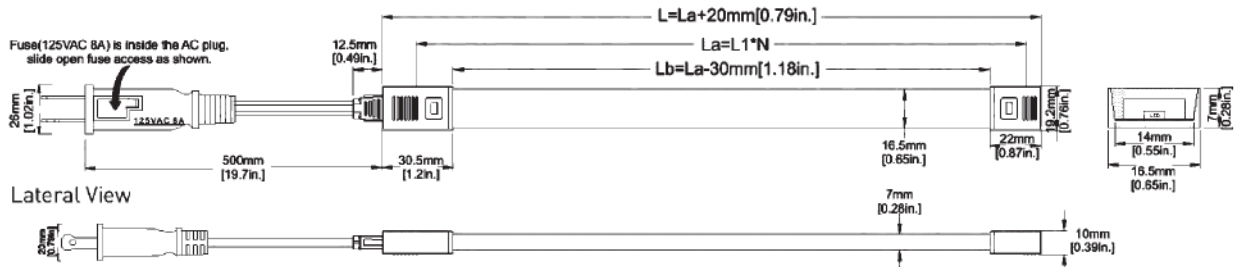

L: Total Length, La: Strip Length, Lb: Light Emitting Length, L1: Strip Increment, N: Quantity in 1,2,3.....

### DRY IP 40

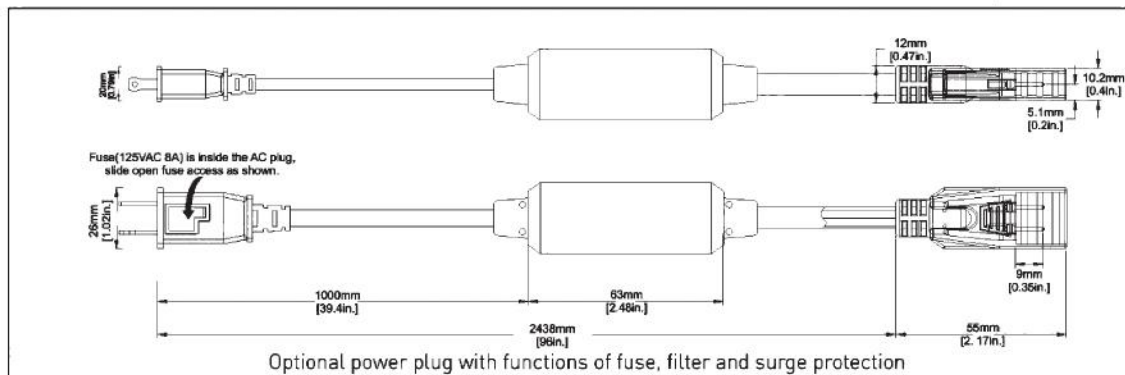
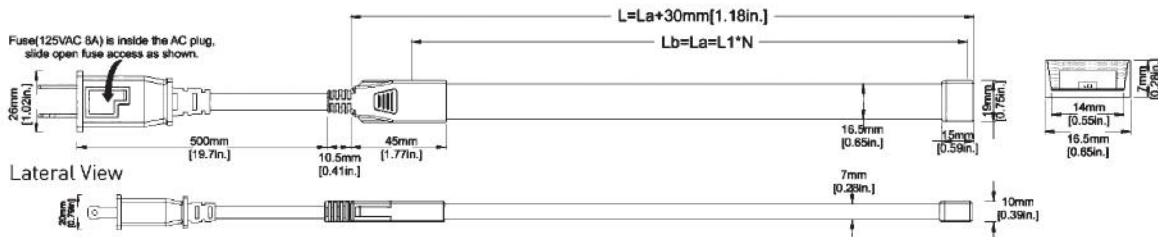

L: Total Length, La: Strip Length, Lb: Light Emitting Length, L1: Strip Increment, N: Quantity in 1,2,3.....

### WET IP 65



RoHS

120 VAC 14 W High-Efficacy  
Dimmable LED Stripe

## SPECIFICATIONS

**Part#:** 331605-000-120-3.7

### PHYSICAL

<b>Part Number</b>	331605-000-120-3.7
<b>Light Efficiency</b>	103-118lm/W
<b>Lumen</b>	1440 -1650 (lm/M) (440 - 500 lm/ft.)
<b>CRI</b>	80+
<b>Light Color</b>	2700K± 120K • 3000K± 150K • 3500K±300K • 4000K±300K • 5000K±400K • 6500K± 500K
<b>IP Rating</b>	IP40 Dry indoor • IP65 Damp (indoor for moisture, outdoor for being covered) IP65 Wet (outdoor for water spray & rain)
<b>Beam Angle</b>	120°
<b>Operating Temperature</b>	-20°C (-4°F) ~ +45 °C (+113 °F)
<b>LED Quantity</b>	80 LED/M (24LED/ft)
<b>Lifespan</b>	50,000 h (indoor) • 36,000h(outdoor)
<b>Dimension</b>	W16 x H7mm • W0.65xH0.28in
<b>Max Length (La)</b>	50 M (164ft)
<b>Strip Increment (L1)</b>	0.2M (8 in)
<b>LED Type / SDCM</b>	SMD2835 / 3 Step 1 Bin

### ELECTRICAL

<b>Input Voltage</b>	120VAC • (110-120VAC)
<b>Power Consumption</b>	14W/M (4.3W/ft)
<b>Power Factor</b>	> 0.8
<b>Certification</b>	ETL • ROHS

#### Note:

- Luminous flux for CCT 2700K is 10% lower, for CCT 3000K/3500K is 5% lower, for CCT 5000K/6500K is the same, compared with 4000K.
- Applying with extra heat sink is not mandatory by self-cooling.
- The standard packing length is 50M[164ft.] per reel without installation accessories. customized packing length need to be re-evaluated.
- Installation accessories pack should be ordered separately according to specific case.
- Fuse replacement rating: Replace fuse only with 8 Amp, 125 Volt fuse.



RoHS

120 VAC 14 W High-Efficacy  
Dimmable LED Stripe

## LIGHT DISTRIBUTION DIAGRAM

Part#: 331605-000-120-3.7

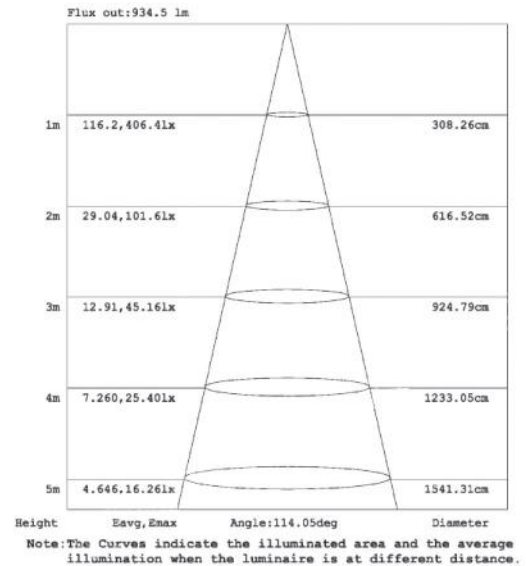
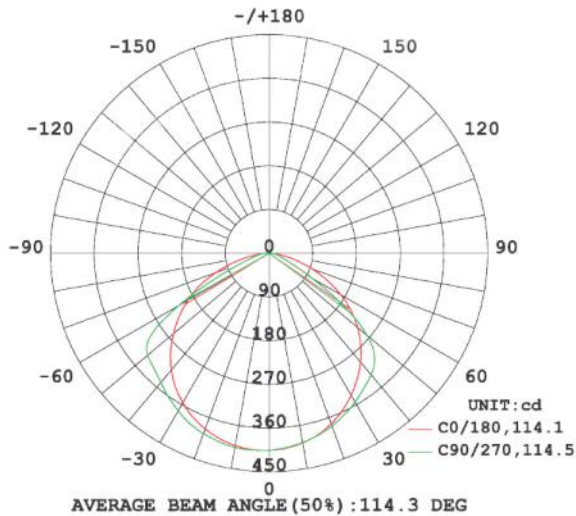

14W/M[4.3W/ft.], CRI90, 3000K

## INSTALLATION ACCESSORIES (UL Certified)

1. Fixed by bracket: Fix the lower cover of bracket to the mounting surface by screw firstly, then insert the strip to the bracket, finally fasten the upper cover.

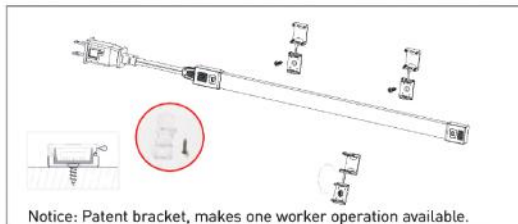

IP40 Dry

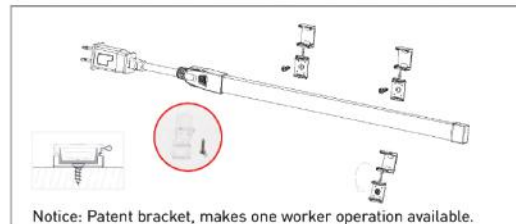

IP65 Wet

2. Fixed by aluminum channel: Fix the aluminum channel to the mounting surface by screw firstly, then insert the strip to aluminum channel, finally fasten the cover to the aluminum channel.

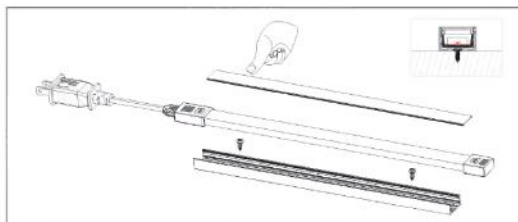

IP40 Dry

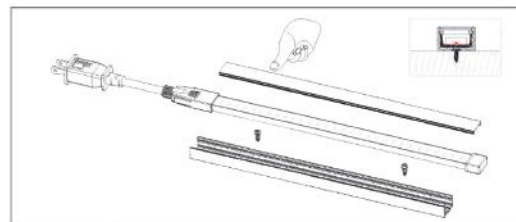

IP65 Wet

## ASSEMBLY ACCESSORIES (UL Certified)

**Part#:** 331605-000-120-3.7

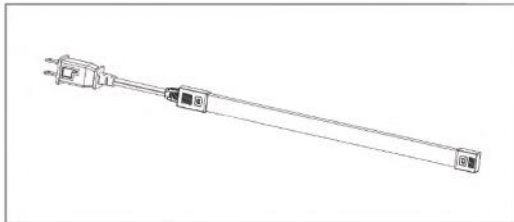

IP40 (Strip Body)

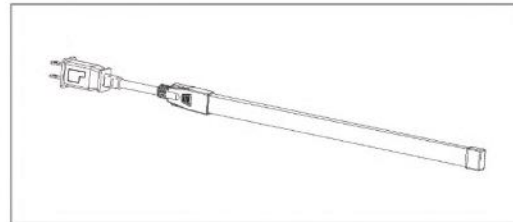

IP65 (Strip Body)

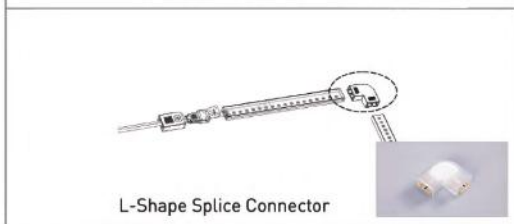
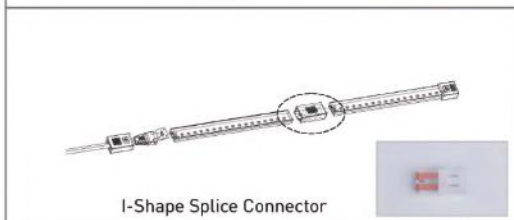
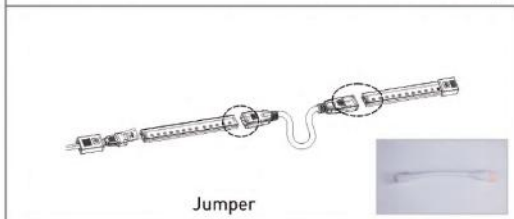
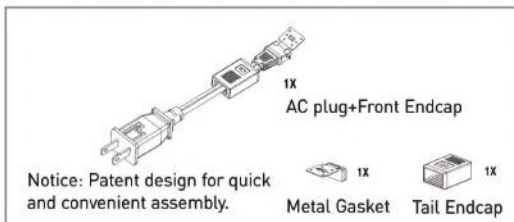

IP40 (Accessories Pack)

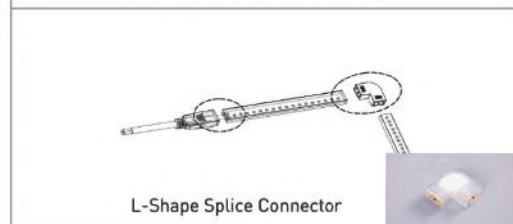
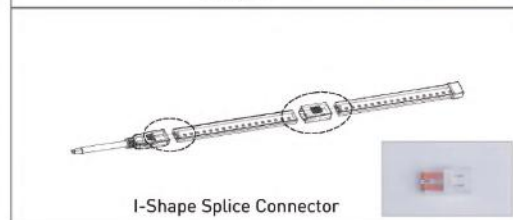
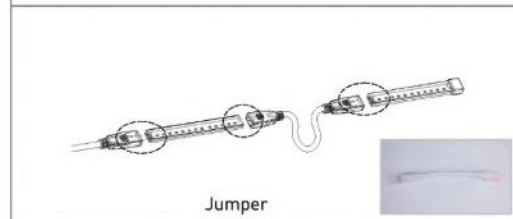
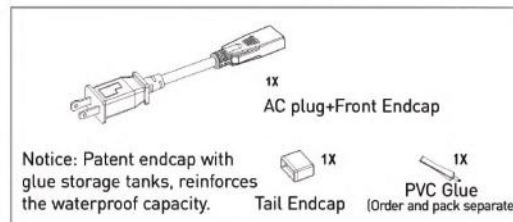

IP65 (Accessories Pack)

## PACKING

**Part#:** 331605-000-120-3.7



## ELETRICAL SPECIFICATIONS

<b>Part No.</b>	331605-000-120-3.7
<b>Style</b>	Top-Bend (Dual-Colors) PVC Extrusion
<b>Product Dimension</b>	1967" (50000mm) L x 0.65" (16.5mm) W x 0.28" (7mm) H
<b>Product N.W.</b>	6.9kg
<b>Carton Size</b>	12.5" (318 mm) L x 12.5" (318 mm) W x 6.1" (155mm) D
<b>Product QTY/Carton</b>	1 pcs
<b>Carton Total G.W.</b>	7.4 kg

### Notice

1. Do not install the luminaire when power is on. Before power on, make sure the wiring is correct.
2. Do not install the IP40 Dry indoor version in outdoor environments, only the IP65 Wet version is rated for outdoor applications.
3. Do not install in environment where excessive heat may exist lex. close proximity to fireplace, etc. See Ambient Temperature ratings.
4. Avoid scrape, twist and irregular-bend during installation, it might cause a non repairable status.
5. To protect your eyes, do not stare at the luminary for a long time while it's illuminated.
6. For cleaning, use a soft, dry or damp cloth. Do not use harsh chemicals or abrasives.

### Plug-in version complied with UL2388

## IMPORTANT SAFETY INSTRUCTIONS

### READ AND FOLLOW ALL SAFETY INSTRUCTIONS

- a) Do not cover this product as the covering may cause the flexible light to overheat and melt or ignite.
- b) Do not operate with the flexible light tightly coiled.
- c) Do not shorten or splice the flexible lighting.
- d) Do not route the cord or lighting through walls, doors, windows or any like part of the building structure.
- e) Do not use if there is any damage to the light or cord. Inspect periodically.
- f) Do not submerge light in liquids or use the product in the vicinity of standing water or other liquids
- g) Secure this flexible light using only the hangers or dips provided. Do not secure this product or its cord with staples, nails, or like means that may damage the insulation or permanently attach to the building structure.
- h) Do not subject lighting to continuous flexing.
- i) This product has a polarized plug (one blade is wider than the other) as a feature to reduce the risk of electric shock. This plug will fit in a polarized outlet only one way. If the plug does not fit fully into the outlet, reverse the plug. If it still does not fit, contact a qualified electrician. Do not use with an extension cord unless plug can be fully inserted. Do not alter or replace the plug.

**WARNING:** When using outdoor, use portable lighting products. Basic safety precautions should always be followed to reduce the risk of fire, electrical shock and personal injury including the following:

Read All Instructions

- a) "Grasp plug and remove from the receptacle or other outlet device. Do not unplug by pulling on cord."
- b) Open fuse cover. The manufacturer shall indicate the specific way to open the cover. Such as, "side open fuse access cover on top of attachment plug towards blades," or "Push on tabs located next to the blades."
- c) Remove fuse carefully. The manufacturer shall indicate the appropriate way to remove the fuse, such as whether to push the fuse from the other side or turn fuse holder over to remove fuse.
- d) Risk of fire. Replace fuse only with 8 Amp, 125 Volt fuse (provided with product).
- e) Close fuse cover. The manufacturer shall indicate the specific way to close the cover. Such as, "slide close the fuse access cover on top of attachment plug," or "push cover closed so that all tabs latch."
- f) Risk of fire. Do not replace attachment plug. Contains a mety device (fuse) that should not be removed.
- g) Ground Fault Circuit Interrupter (GFCI) protection should be provided on the circuits or outlet to be used for the outdoor use flexible lighting product. Receptacles are available having built-in GFCI protection for this measure of safety



## CAUTION

**Part#:** 331605-000-120-3.7

